

EMERGENCY LAST WILL AND TESTAMENT

Form 886513E1.2 Strictly for Use by Authorized
CODE YELLOW Military Personnel Pursuant to
Being Jettisoned from Exploding Third Union
Stellar Patrol Class VII Long-Range RECON
Space Vehicle via XB-813 Mil-Spec Quadratic
Escape Pod in the Event of Impending Fatal
Disasters Consequent to

PLANETFALL™

Keep this document in its designated XB-813
Mil-Spec Quadratic Escape Pod. STRICTLY
FOR AUTHORIZED USE ONLY. Document is
DEFINITELY NOT TO BE USED for drawing map
of uncharted terrain following successful
Planefall. Should any misuse or abuse of
this document be perpetrated by the holder,
said holder will have his or her or its elbows
stapled together, and then be executed until
dead. (See Form 886513E1.5: "Emergency
Last Will and Testament for Use in the Event
of Impending Fatal Disasters Consequent to
Courtmaritaling.")

INFOCOM™

The next dimension.

Infocom, Inc., 35 Wheeler St., Cambridge, MA 02138

Planefall is a trademark
of Infocom, Inc.

© 1983 Infocom, Inc.
Printed in U.S.A.

STELLAR PATROL

OFFICE OF MILITARY JUSTICE AND COURT MARTIALING PROCEDURES

GOVT. ISSUE NO. 886513E1.2 DOC. NO. SWIZ/3950274621.U/B75

(PLEASE PRINT in purple ink and attach any and all additional documents to lower left-hand corner with Adhesion-7 Astrotape.)

Whereas, I (Stellar Patrol CODE YELLOW Officer above the Rank of Ensign 6th Class¹) ,
 (your serial number here) , being of sound mind and body and in mortal peril, do hereby testify and avow and
 otherwise swear on my mother's head² that the Stellar Patrol is in no way responsible for my demise;

And **wherefore** I acknowledge my sole culpability for loss or damage to military property, to wit: one (1) Govt. Issue Third Union Suit³;
 one (1) SB-813 Quadratomic Mil-Spec Escape Pod Model No. ; and all other possessions and appurtenances on and/or about
 my body;

Therefore, I the undersigned do hereby accept my debt to the Stellar Patrol⁴, and bequeath such portions of my personal fortune as
 remains to (here list all non-tax-exempt Third Union citizens to whom you wish to bequeath part of you estate⁵):

Signed this day of (month) in the year T.G.U. by
 I, (sign here).

1 If holder is below rank of Ensign 6th Class, please proceed to Form 8812/4D2.3a: "Emergency Last Will and Testament for Use in the Event of Impending Fatal Disasters Consequent to Being Shot on Sight by a Superior for Illicit Entry of XB-813 Quadratomic Mil-Spec Escape Pod Model No."

2 If holder's mother has no head, please proceed to Form 873461H2.7j: "Emergency Last Will and Testament for Born Idiots."

3 If holder was not wearing uniform and/or 3-U suit when jettisoned, please proceed to Form 8152/4Y9.Op: "Emergency Last Will and Testament for Use in the Event of Impending Fatal Disasters Consequent to Being Caught Dead Out of Uniform."

4 To determine the exact amount of your debt to the Stellar Patrol, take the sum value of all moneys, possessions, properties, and other valuables that make up your gross personal estate and multiply by 0.01; then subtract the dividend

from the original sum and remit that amount to the Stellar Patrol. Now subtract 55% of the remaining estate and remit it to the Third Union Will Execution and Paper Processing Tax Service. The remainder is your net fortune. (However, certain regional star cluster and local taxes may apply.)

5 Not to exceed one item per heir; nor should items exceed an individual value of 71 credits.

ALL OTHER POSSESSIONS I HEREBY BEQUEATH TO THE STELLAR PATROL ADMIRALS' SHUFFLEBOARD TOURNAMENT FLORAL DECORATIONS FUND-RAISING COMMITTEE:

LEGEND:

- NORMAL PASSAGEWAY
- - - ONE-WAY PASSAGEWAY

--- PASSAGEWAY REQUIRING SPECIAL EQUIPMENT OR PROBLEM SOLVING

NOTE: I HAVE ONLY LISTED THE OBJECTS THAT CAN BE TAKEN AND THAT ARE VISIBLE WHEN I FIRST ENTERED A ROOM, WHERE MORE THAN ONE DIRECTION LEADS TO THE SAME PLACE, I ONLY SHOWED THE ONE I USED FIRST.

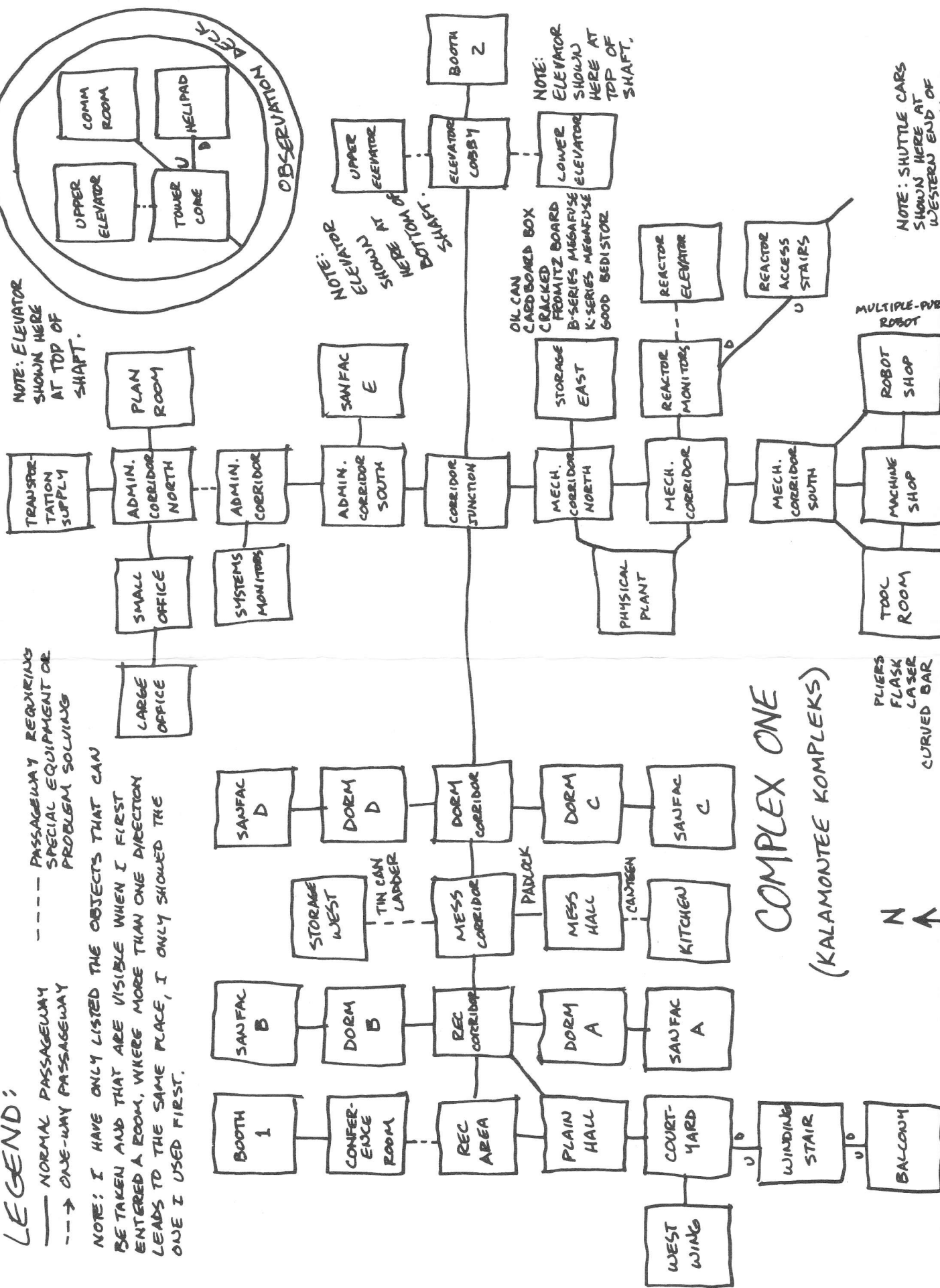
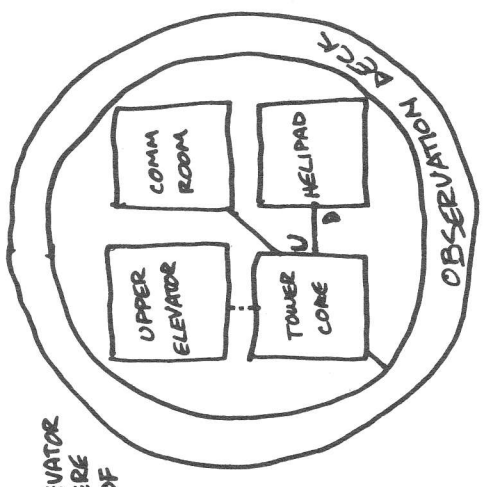

COMPLEX ONE
(KALAMONTEE KOMPLEXES)



COMPLEX TWO (LAWANDA KOMPLEXES)

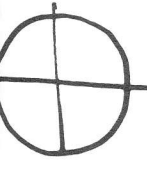
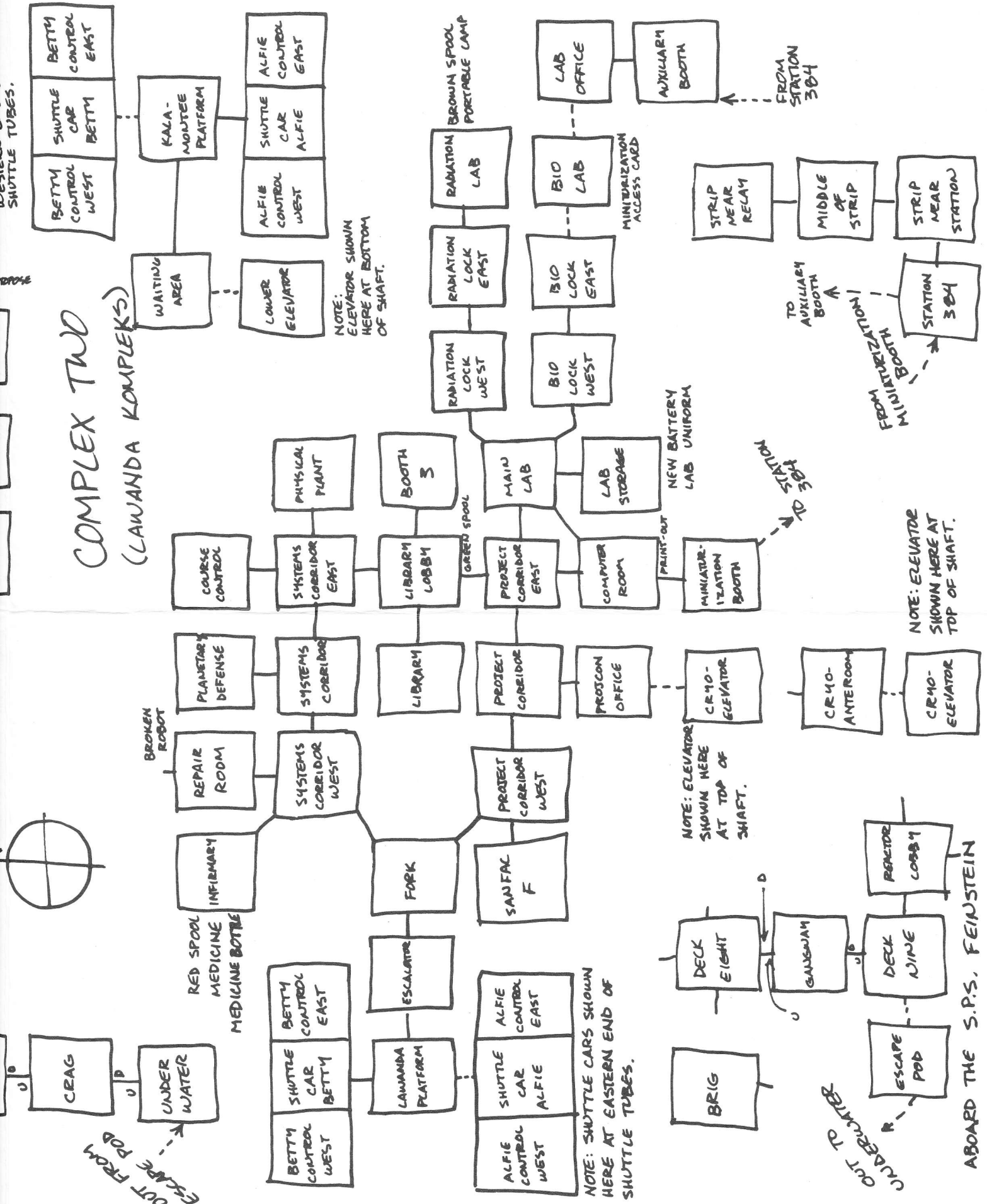

OUT FROM ESCAPE POD

OUT TO UNDERWATER

ABOARD THE S.P.S. FEINSTEIN

NOTE: ELEVATOR SHOWN HERE AT BOTTOM OF SHAFT.

NOTE: ELEVATOR SHOWN HERE AT TOP OF SHAFT.

NOTE: ELEVATOR SHOWN HERE AT TOP OF SHAFT.

STATION 304

MINI-BOTHS FROM MINIALIZATION!

TO AUXILIARY BOOTH

FROM STATION 304

NEW BATTERY LAB UNIFORM

PRINT-OUT

MINIALIZATION ACCESS CARD

BROWN SPOOL PORTABLE CAMP

WAITING AREA

KALA-MONJEE PLATFORM

LOWER ELEVATOR

PHYSICAL PLANT

BOOTH 3

RADIATION LOCK WEST

RADIATION LOCK EAST

RADIATION LAB

BIO LOCK WEST

BIO LOCK EAST

BIO LAB

LAB OFFICE

AUXILIARY BOOTH

COURSE CONTROL

SYSTEMS CORRIDOR EAST

LIBRARY LOBBY

PROJECT CORRIDOR EAST

COMPUTER ROOM

MINIALIZATION BOOTH

PLANETARY DEFENSE

SYSTEMS CORRIDOR

LIBRARY

PROJECT CORRIDOR

PROSCON OFFICE

CR40-ELEVATOR

REPAIR ROOM

SYSTEMS CORRIDOR WEST

PROJECT CORRIDOR WEST

CR40-ANTEROOM

CR40-ELEVATOR

INFIRMARY

FORK

ESCULATOR

SANFAC F

DECK EIGHT

GAUSSWAY

DECK NINE

REACTOR LOBBY

UNDER WATER

ESCAPE POD

LAWANDA PLATFORM

SHUTTLE CAR ALFIE

SHUTTLE CAR BETTY

BRIG

ESCAPE POD

ALFIE CONTROL WEST

ALFIE CONTROL EAST

BETTY CONTROL WEST

BETTY CONTROL EAST

ALFIE CONTROL WEST

ALFIE CONTROL EAST

LAB STORAGE

STRIP NEAR RELAY

MIDDLE OF STRIP

STRIP NEAR STATION

STATION 304